

C004A

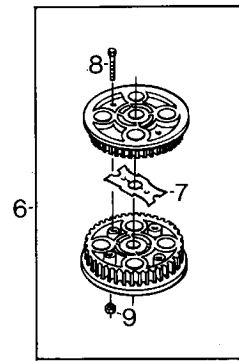

Ausgabe Issue 2003-3		Bild Nr Picture No C004A		MÄHWERK 85M RAHMEN REGULIERUNGEN		FRONT DECK 85M FRAME CONTROLS		Seite Page 60	
Pos. Fig.	Anzahl/Quantity			Artikel Nr. Part No	Bezeichnung	Description	Satz Kit	Anmerkung Notes	
	2916 -55	2916 -85							
1	2	2		1134-3031-01	Distanz.....	Spacer.....			
2	1	1		1134-3038-01	Riemenschutz.....	Belt guard.....			
3	2	2		9997-1055-12	Schraube.....	Screw.....			
5	3	3		9836-9512-12	Schraube.....	Screw.....			
6	1	1		1134-3037-01	Deckel.....	Transmission cover.....			
7	2	2		9945-0816-16	Schraube.....	Screw.....			
8	1	1		1134-3017-02	Rahmen- schw.....	Frame- black.....			
9	1	1		1134-3042-01	Feder.....	Spring.....			
10	1	1		1134-1605-02	Kette.....	Chain.....			
11	1	1		1134-1889-01	Schrauböse.....	Eyebolt.....			
12	1	1		9699-0100-02	Scheibe.....	Washer.....			
13	1	1		1134-3033-01	Schutzschlauch.....	Hose.....			
16	1	1		1134-0304-05	Welle.....	Shaft.....			
17	2	2		9935-1020-16	Schraube.....	Screw.....			
18	8	8		1134-2406-01	Schutzrolle.....	Guard roller.....			
19	2	2		1134-2405-01	Haubenrad.....	Casing wheel.....			
20	4	4		1134-3047-01	Distanz.....	Spacer.....			
20A	2	2		9699-0104-02	Scheibe.....	Washer.....		Shims- not ill.	
22	1			1134-3025-01	Chassie- gelb.....	Casing- yellow.....			
22		1		1134-3025-03	Chassie- rot.....	Casing- red.....			
23	1	1		1134-3029-01	Anschlag.....	Stop bracket.....			
24	1	1		1134-3015-02	Justierstrebe- L.....	Adjusting bracket- L.H.....			
24A	1	1		1134-3015-01	Justierstrebe- R.....	Adjusting bracket- R.H.....		Not ill.	
25	13	13		9959-0820-16	Schraube.....	Screw.....			
26	13	13		9739-0831-22	Mutter.....	Nut.....			
27	1	1		1134-5056-02	Halterung- L.....	Bracket- L.H.....			
27A	1	1		1134-5056-01	Halterung- R.....	Bracket- R.H.....		Not ill.	
30	2	2		1134-2907-03	Schwenkplatte.....	Pivoting plate.....			
31	6	6		1134-0240-00	Ansatzbolzen.....	Shoulder screw.....			
32	1	1		1134-2411-01	Halterung.....	Bracket.....			
33	1	1		1134-3013-01	Achse.....	Shaft.....			
34	2	2		1134-1833-02	Strebe.....	Rod.....			
35	4	4		9675-0012-02	Verriegelungsscheibe.....	Locking washer.....			
36	1	1		1134-3011-01	Höhenverstellsegment.....	Height adj. quadrant.....			
X 37	1	1		1134-5215-01	Höheneinst.hebel Kpl.....	Height adj.lever assy.....		Pos. 42- 50,52 incl.	
38	1	1		1134-2427-01	Distanz.....	Spacer.....			
40	1	1		9997-0825-16	Schraube.....	Screw.....			
41	7	7		9747-0831-02	Mutter.....	Lock nut.....			
X 42	1	1		1134-3010-02	• Schloßsegment.....	• Locking quadrant.....			
43	1	1		9997-0620-16	• Schraube.....	• Screw.....			
44	1	1		9747-0631-02	• Mutter.....	• Lock nut.....			
45	1	1		1134-3262-01	• Druckfeder.....	• Compression spring.....			
47	1	1		1134-3009-01	• Schloßkeil.....	• Locking key.....			
48	1	1		1134-3041-01	• Regulierstange.....	• Control rod.....			
49	1	1		1134-3051-01	• Sperrknopf.....	• Locking knob.....			
50	1	1		9406-0006-00	• Griff.....	• Handle.....			
51	1	1		1134-3026-02	HöhenEinstellsegment.....	Height measure plate.....			
X 52	1	1		1134-5114-01	• Distanz.....	• Spacer.....			
99	1	1		9402-3203-00	Aufkleber m.Symbolen.....	Warn. label w.Symbols.....		Not ill.	

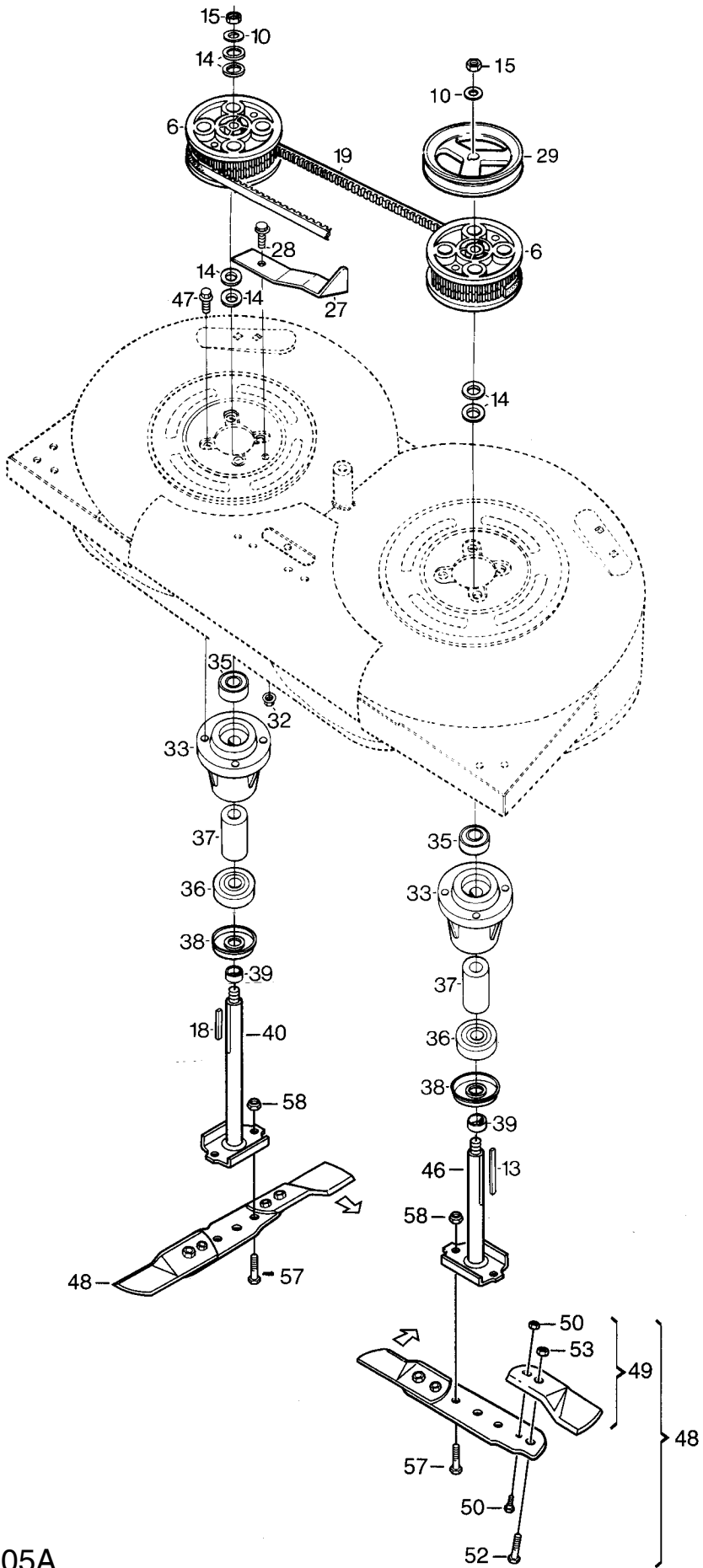

C005A



Ausgabe Issue		Bild Nr Picture No		MÄHWERK 85M MESSER		FRONT DECK 85M BLADES		Seite Page	
2003-3		C005A						62	
Pos. Fig.	Anzahl/Quantity			Artikel Nr. Part No	Bezeichnung	Description	Satz Kit	Anmerkung Notes	
	2916 -55	2916 -85							
	6	2	2	1134-3679-01	Riemenscheibe kompl	Toothed belt pulley			
	7	1	1	1134-3597-01	• Verstärkung	• Reinforcement			
	8	2	2	9997-0625-16	• Schraube	• Screw			
	9	2	2	9747-0631-02	• Mutter	• Lock nut			
X	10	2	2	1134-5236-01	Scheibe	Washer			
	13	1	1	1134-0323-02	Keil	Key		L = 54 mm	
	14	6	6	9699-0104-02	Scheibe	Washer			
	15	2	2	1134-4775-01	Schloßmutter	Lock nut			
	18	1	1	1134-0323-01	Keil	Key		L = 25 mm	
	19	1	1	9585-0071-00	Zahnriemen	Toothed belt			
	27	1	1	1134-3014-01	Riemenspanner	Belt tensioner			
	28	1	1	9959-0820-16	Schraube	Screw			
	29	1	1	1134-3035-01	Riemenscheibe	Belt pulley			
	32	1	1	9739-0831-22	Mutter	Nut			
	33	2	2	1134-3841-01	Lagerbuchse Kpl.	Bearing box assy			
	35	1	1	9549-0019-00	• Kugellager	• Ball bearing			
	36	1	1	9549-0020-00	• Kugellager	• Ball bearing			
	37	1	1	1134-0051-05	• Distanz	• Spacer			
	38	2	2	1134-3768-01	Schutzscheibe	Bearing cover			
	39	2	2	1134-3725-01	Distanz	Spacer			
	40	1	1	1134-4600-01	Messerwelle	Blade shaft			
	46	1	1	1134-4600-02	Messerwelle	Blade shaft			
	47	8	8	9945-0825-16	Schraube	Screw			
X	48	2	2	1134-5074-01	Messerbalken Kpl.	Blade bar assy			
X	49	1	1	1134-9082-01	• Messersatz Kpl.	• Blade kit		2 blade tips	
	50	1	1	1134-9054-01	•• Scherbolzensatz	•• Shear bolt kit		6 bolts+nuts	
	52	2	2	9997-0816-16	•• Schraube	•• Screw			
	53	2	2	9712-0831-02	•• Mutter	•• Lock nut			
	57	4	4	9997-0820-16	Schraube	Screw			
	58	4	4	9747-0831-02	Mutter	Lock nut			