

# MODEL 83-9422

Ref. Part No.	Description
1	Engine
2	Base, 22" Rear Drive S.P.
3	Handle Bracket (L&R)
4	Rear Deflector
5	Chute Deflector, Poly
6	Wheel, 8" Drive (Rear)
7	Wheel, 8" Poly (Front)
8	Axle, Rear
9	Axle, Front
10	Height Adjuster, Pivotal Left Rear
11	Height Adjuster, Pivotal Right Rear
12	Height Adjuster, Pivotal Front
13	Handle, Lower
14	Handle, Upper
15	Throttle Control
16	Blade Brake Control Cable - Quantum
17	Blade Brake Control Cable - Sprint or Classic
18	Blade Brake Control Bar
19	Self-Propel Control Bar
20	Recoil Starter Mounting Bolt
21	Cable Tie
22	Self-Propel Drive Cable
23	Drive Wheel Cover
24	Mounting Ring, Engine
25	Pinion Gear - Left
26	Pinion Gear - Right
27	Pinion Gear Dowel Pin 3/16" x 3/4"
28	Driveshaft Cover
29	Bracket, Cable & Belt Cover
30	Bracket, Engine & Belt Cover
31	Cover, Variable Drive System
32	Pulley, Engine 2 1/2" OD x 1/2" Bore
33	Belt # 3L340
34	Variable Drive System w/Pulley & Shaft
35	Spacer, Engine Mounting Ring
36	Lever & Bracket Speed Control
37	Control Bar Stop Bracket
38	Blade, 22"
39	Blade, 22" (Mulching mowers only)
40	Blade Adapter (2 3/16")
41	Blade Bolt (3/8" x 2 1/2") H.T.
42	Lockwasher
43	Pivot Bolt
44	Wing Nut - STD
45	Wing Knob - Deluxe
46	Mulcher Plate (Mulching mowers only)
47	
48	
49	
50	
51	
52	
53	
54	
55	
56	
57	
58	
59	
60	
61	
62	
63	
64	
65	
66	
67	
68	
69	
70	
71	
72	
73	
74	
75	
76	
77	
78	
79	
80	
81	
82	
83	
84	
85	
86	
87	
88	
89	
90	
91	
92	
93	
94	
95	
96	
97	
98	
99	
100	

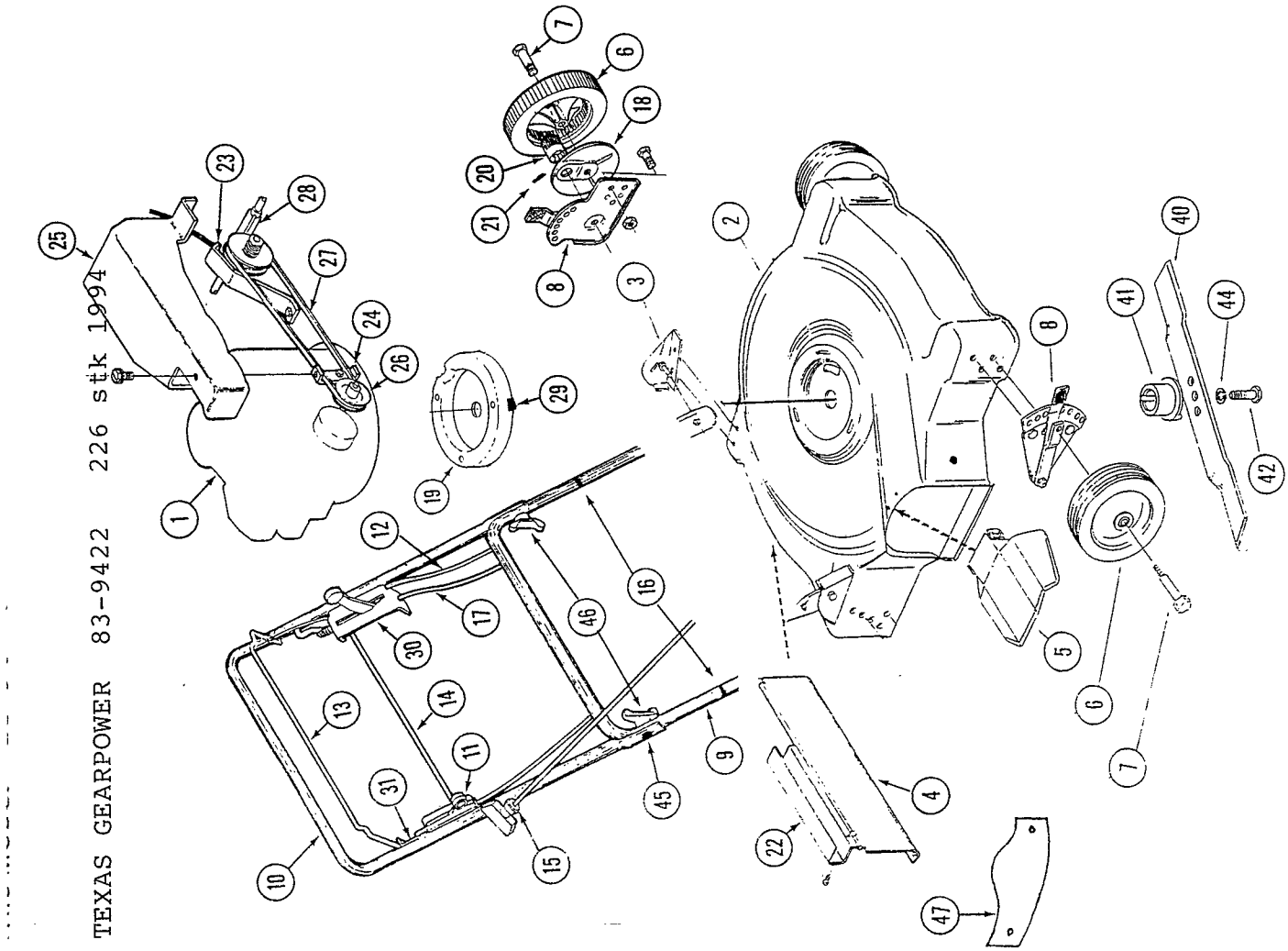

Grass Catcher No. 387 is available for this model. Contact your dealer or the factory for information.

Physical appearance of parts may differ slightly from illustrations.

TEXAS GEARPOWER 83-9422 226 s.t.k. 1994