

# FIG. 2 CG260E BUSH CUTTER

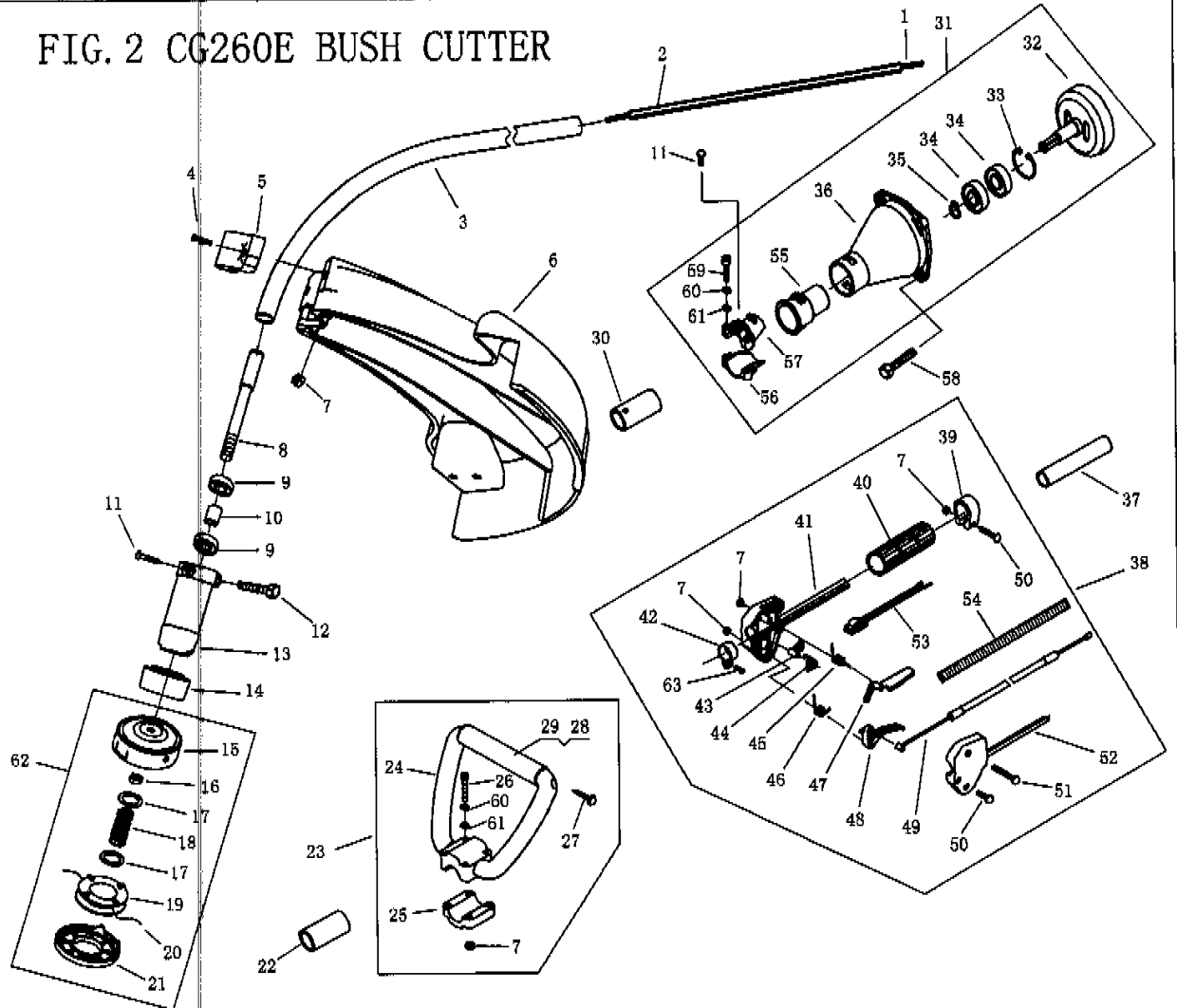

NO.	Part NO.	Part Name	Qty.	NO.	Part NO.	Part Name	Qty.	NO.	Part NO.	Part Name	Qty.
1	CG305F. 5	Flexible Shaft	1	22	CG260E-3	Bush	1	43	CG305F. 13-10	Tine	1
2	CG260E. 1-2	Bracket	1	23	CG305F. 6	Holder Ass'y	1	44	CG305F. 13-11	Spring	1
3	CG260E. 1-1	Pipe	1	24	CG305F. 6-1	Holder	1	45	CG305F. 13-9	Spring	1
4	GB/T9074. 13	Screw M5×25	2	25	CG305F. 6-2	Cap, Lower	1	46	CG305F. 13-1	Spring	1
5	CG260E-6	Holder	1	26	GB/T70. 1	Screw M5×35	4	47	CG305F. 13-8	Safety Lever	1
6	CG260E-5	Safety Guard	1	27	GB/T845	Screw ST4. 8×22	2	48	CG305F. 13-2	Throttle Lever	1
7	GB/T889. 1	Nut M5	13	28	CG305F. 6-3	Core Shaft	2	49	CG260. 2. 2	Cable Comp.	1
8	CG260E. 2-1	Linker Shaft	1	29	CG305F. 6-4	Handle Cover	1	50	GB/T9074. 4	Screw M5×25	2
9	GB/T276	Bearing 608-2RS/P5	2	30	CG260E-1	Bush	1	51	CG305F. 13-3	Box, Left	1
10	CG260E. 2-4	Pipe	1	31	CG260. 1	Clutch Comp.	1	52	CG305F. 13-3	Box, Left	1
11	GB/T9074. 4	Screw M5×12	2	32	CG260. 1. 1	Clutch Drum Comp.	1	53	CG260. 2. 1	Stop Switch	1
12	GB/T9074. 13	Screw M5×20	1	33	GB/T893. 1	Stop Ring 35	1	54	CG260. 2-1	Tube	1
13	CG260E. 2-3	Linker	1	34	GB/T276	Bearing 6202-2RS/P5	2	55	CG305F. 14-2	Rubber Cover	1
14	CG260E. 2-2	Holder	1	35	GB/T894. 1	Stop Ring 15	1	56	CG305F. 14-3	Clamp B	1
15	CG305F. 8. 1	Case	1	36	CG260. 1-1	Linker	1	57	CG305F. 14-4	Clamp A	1
16	CG260E-T2	Right Nut	1	37	CG260E-2	Bush	1	58	GB/T9074. 13	Screw M6×20	4
17	CG305F. 8-5	Washer	2	38	CG260. 2	Lever Ass'y	1	59	GB/T70. 1	SCREW M5×25	2
18	CG305F. 8-3	Spring	1	39	CG305F. 13-5	Clamp	1	60	GB/T97. 1	Washer 5	6
19	CG305F. 8-1	Cord Holder	1	40	CG305F. 13-6	Rubber Cover	1	61	GB/T93	Washer 5	6
20		Cord Φ2. 5×4200	1	41	CG305F. 13-4	Box, Right	1	62	CG305F. 8	Nylon Cutter Head	1
21	CG305F. 8-2	Cover	1	42	CG305F. 13. 2	Clamp	1	63	GB9074. 4	Screw M5×16	1

# FIG. 1 IE34F GASOLINE ENGINE

Engine : 110260

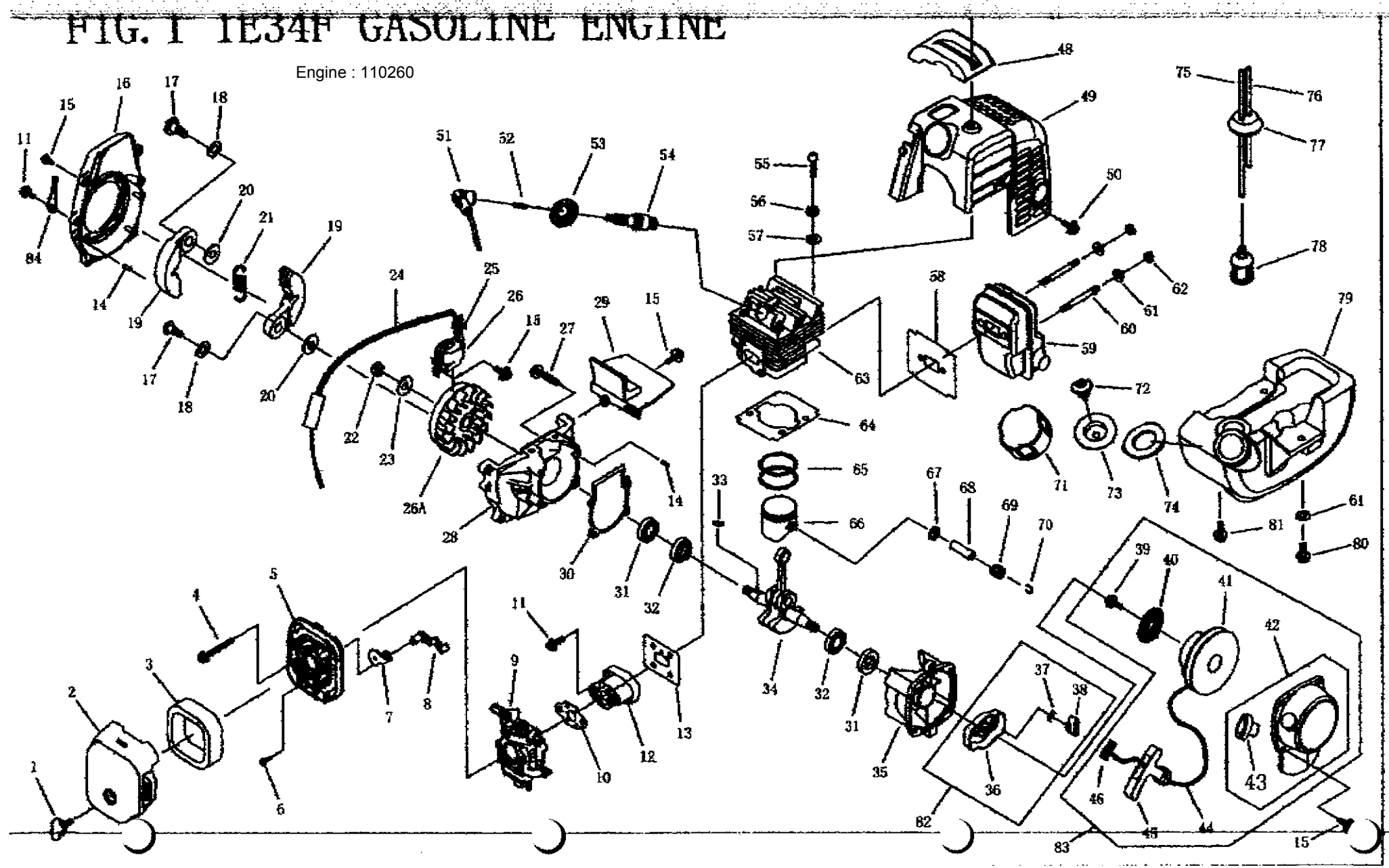

R. NO	PART NO.	PART NAME	QTY.	SER. NO	PART NO.	PART NAME	QTY.	SER. NO	PART NO.	PART NAME	QTY.
1	1E34F. 1.2	SCREW	1	29	1E34F-4	GUIDE PLATE	1	58	1E34F-3	GASKET	1
2	1E34F. 1-4	CLEANER OUTSIDE COVER	1	30	1E34F. 7-2	CRANK CASE GASKET	1	59	1E34F. 2	MUFFLER COMP.	1
3	1E34F. 1-1	CLEANER ELEMENT	1	31	1E36F. 2	OIL SEAL	2	60	1E34F-14	BOLT	2
4	GB9074. 4	SCREW M5x55	2	32	GB276	BALL BEARING 6001/P5	2	61	GB96	WASHER 5	3
5	1E34F. 1. 1	CLEANER INSIDE COVER	1	33	1E40FP-32. 3-1	KEY	1	62	GB6187	NUT M5	2
6	GB845	SCREW ST4. 2x12-F-H	1	34	1E34F. 6. 1	CRANK SHAFT COMP.	1	63	1E34F-8	CYLINDER	1
7	1E34F. 1-3	CHOKE	1	35	1E34F. 7-3	REAR HALF CRANK CASE	1	64	1E34F-9	CYLINDER WASHER	1
8	1E34F. 1-2	CHOKE HANDLE	1	36	1E34F. 8. 1	STARTER PULLEY ASS'Y	1	65	1D34F. 6-5	PISTON RING	2
9	WYJ 244	CARBURETOR	1	37	1E34F. 8-2	STARTER PAWL SPRING	1	66	1E34F. 6-6	PISTON	1
10	1E34F-1	GASKET	1	38	1E34F. 8-1	STARTER PAWL	1	67	1E34F. 6-1	STOP RING	2
11	GB9074. 4	SCREW M5x20	6	39	GB9074. 6	SCREW M5x10	1	68	1E34F. 6-3	PISTON PIN	1
12	1E34F. 4	INLET MANIFOLD	1	40	1E34F. 11-1	RECOIL SPRING	1	69	1E34F. 6-4	NEEDLE BEARING	1
13	1E34F-2	CYLINDER WASHER	1	41	1E34F. 11-2	STARTER ROPE REEL	1	70	1E34F. 6-2	PISTON PIN CIRCLET	2
14	GB119	ANNUIL B3x10	4	42	1E34F. 11. 1	RECOIL STARTER BODY	1	71	EB-415. 4. 1-1	FUEL TANK LID	1
15	GB9074. 4	SCREW M4x16	9	43	1E34F. 11. 1-1	ROPE GUIDE	1	72	EB-415. 4. 1. 1-1	ATRIINLET MOUTH	1
16	1E34F-6	FAN COVER	1	44	1E34F. 11-3	ROPE	1	73	EB-415. 4. 1. 1-3	FRAME	1
17	1E34F-12	CLUTCH STEP SCREW	2	45	1E36F. 1-1	STARTER HANDLE	1	74	EB-415. 4. 1. 1-2	GASKET	1
18	1E34F-13	WASHER	2	46	1E36F. 1-5	GASKET	1	75	1E34F. 9. 2-2	OUTLET FUEL PIPE	1
19	1E34F. 10. 1	CLUTCH SHOE COMP.	2	47	GB9074. 4	SCREW M5x14	1	76	1E34F. 9. 2-1	INLET FUEL PIPE	1
20	1E34F-11	WASHER	2	48	1E34F-6	COVER	1	77	1E36FF. 8. 1-1	PRIMARY CORD GROMMET	1
21	1E34F. 10-1	CLUTCH SPRING	1	49	1E34F. 3	COVER	1	78	1E34F. 9. 2-3	CLEANER	1
22	GB6171	NUT M8x1	1	50	GB9074. 4	SCREW M4x12	1	79	1E34F. 9. 1	FUEL TANK	1
23	GB97. 1	WASHER 8	1	51	1E34F. 5-2	PLUG CAP	1	80	GB9074. 3	SCREW M5x16	1
24	QQ-1	STOP CORD COMP.	1	52	1E40F-3A. 8-2	CLICK SPRING	1	81	GB9074. 4	SCREW M5x16	2
25	1E34F. 5-1	PRIMARY CORD GROMMET	1	53	1E34F. 5-3	PLUG COVER	1	82	1E34F6	STARTER PULLEY ASS' S	1
26	UK-08922	MAGNETO STATOR	1	54	RCJ6Y(CHAMPION)	SPARK PLUG	1	83	1E34F8	STARTER	1
26A	UK-08922	MAGNETO ROTOR	1	55	GB70	SCREW M5x20	4	84	1E36FF-11	FLASH PAN	1
27	GB907/	SCREW M5x25	4	56	GB93	WASHER 5	4				
28	1E34F. 7-1	FRONT HALF CRANK CASE	1	57	48	WASHER 5	4				